

Location Check In

Available in Version 3.1.0

Release Date: 8.4.15



With your permission, Safeguard Properties would like to track your location. This is **not** required to do business with Safeguard. Location check in functionality allows Safeguard Properties to capture your location every 15 minutes from 7am – 7pm daily, but only while the application is open on your device. We will **only** use this information as an aid for assigning rush work orders based on your current location. You may choose to opt of collection at any time within the settings option.

The information is subject to our [Privacy Policy](#). A link to the privacy policy can be found on the log in screen

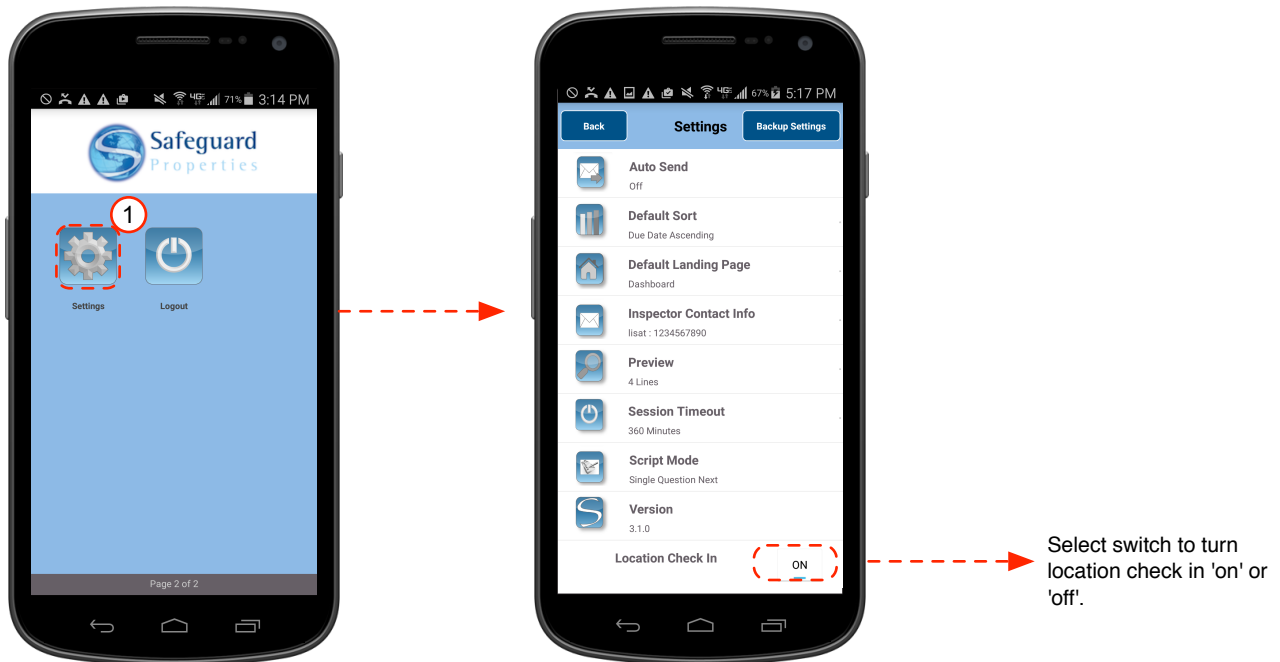

- 1 To access the settings swipe left on the Main Menu page then select the Settings icon.

*If you need assistance or have any question s please call the Help Desk at 800-852-8306 ext. 3999
Additional training materials can be found on spivendor.com under the mobile tab*

Location Check In

Available in Version 3.1.0

Release Date: 8.4.15



With your permission, Safeguard Properties would like to track your location. This is **not** required to do business with Safeguard. Location check in functionality allows Safeguard Properties to capture your location every 15 minutes from 7am – 7pm daily, but only while the application is open on your device. We will **only** use this information as an aid for assigning rush work orders based on your current location. You may choose to opt of collection at any time within the settings option.

The information is subject to our [Privacy Policy](#). A link to the privacy policy can be found on the log in screen

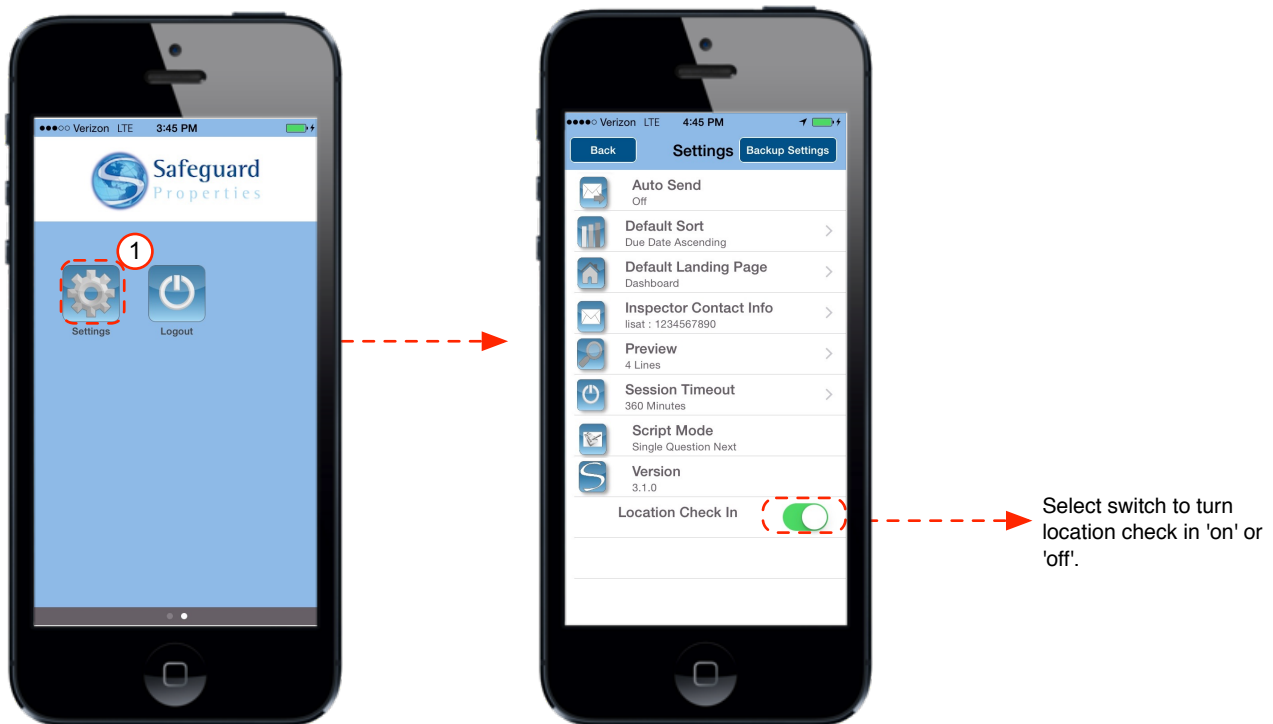

- 1 To access the settings swipe left on the Main Menu page then select the Settings icon.

*If you need assistance or have any question s please call the Help Desk at 800-852-8306 ext. 3999
Additional training materials can be found on spivendor.com under the mobile tab*